

3137X10\_65 NH DR46 [pg 1]

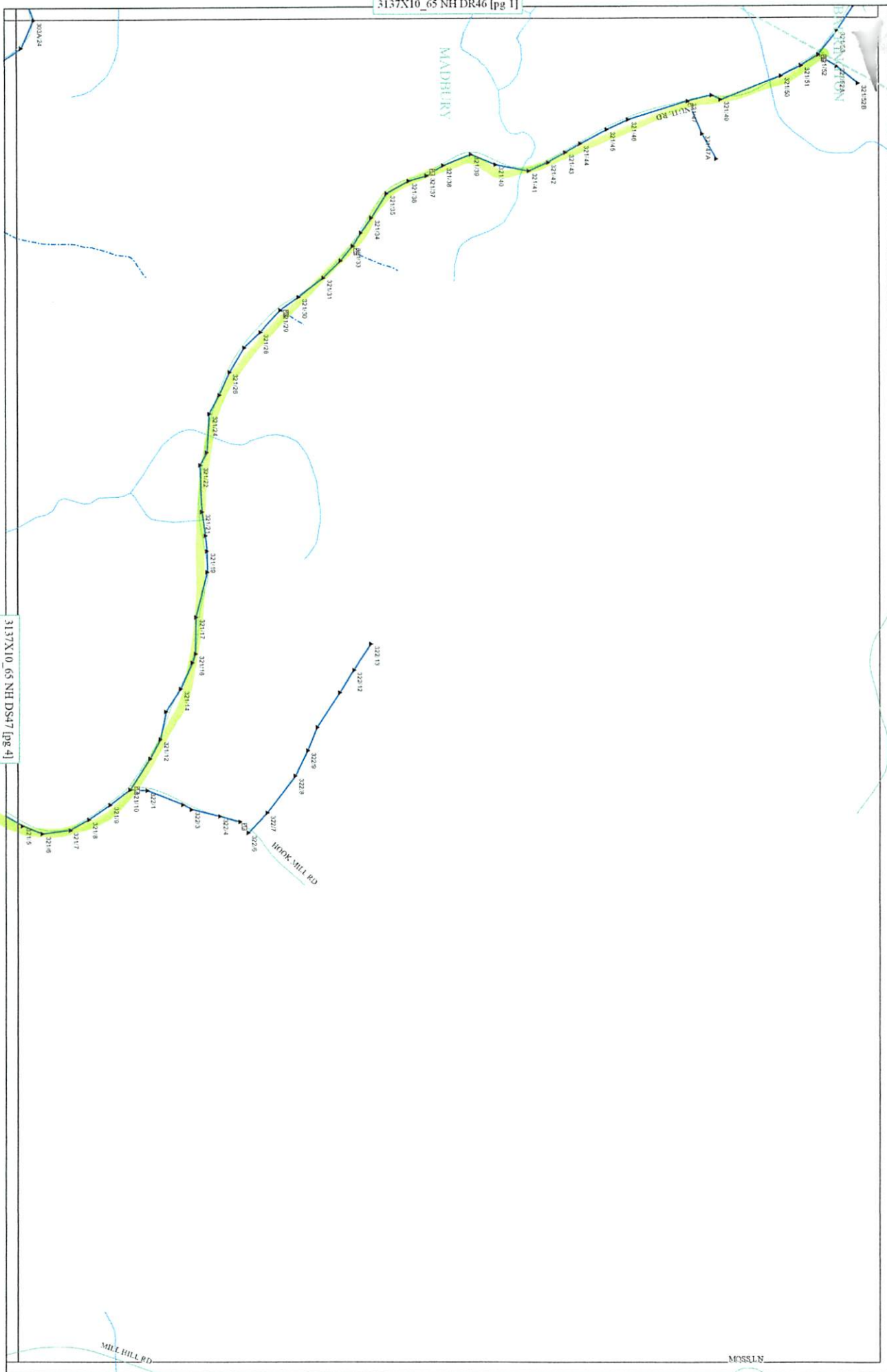

**EVERSOURCE ENERGY GIS**

PROPRIETARY INFORMATION: The material contained on the Overhead Distribution Circuit Map shall be considered proprietary to Eversource Energy, and Users entities shall be deemed to any person or entity who has received the Map shall be deemed to have received the same in confidence and shall not be disclosed or made available to any third party without the prior written permission of Eversource Energy.

0 400 800 1,200 Feet  
1 inch = 400 feet

- Cutout
- ▲ Pole
- Recloser
- Switch Bank
- Open Point
- ▲ Stepdown Bank
- ▲ Tripoint
- OH Primary
- OH Backbone
- OH Lateral
- UG Primary
- UG Backbone
- UG Lateral
- Hydrology
- Streets
- Substation
- Town Boundaries

**Circuit Mileage**

Backbone	2.30
Lateral	12.32
<b>Total</b>	<b>14.63</b>



Page:

2 of 5

**3137X10\_65 NH DR47**

Circuit: 3137X10\_65  
District: Eastern  
AWC: Epping  
**EVERSOURCE ENERGY**

Printed:  
6/15/2020



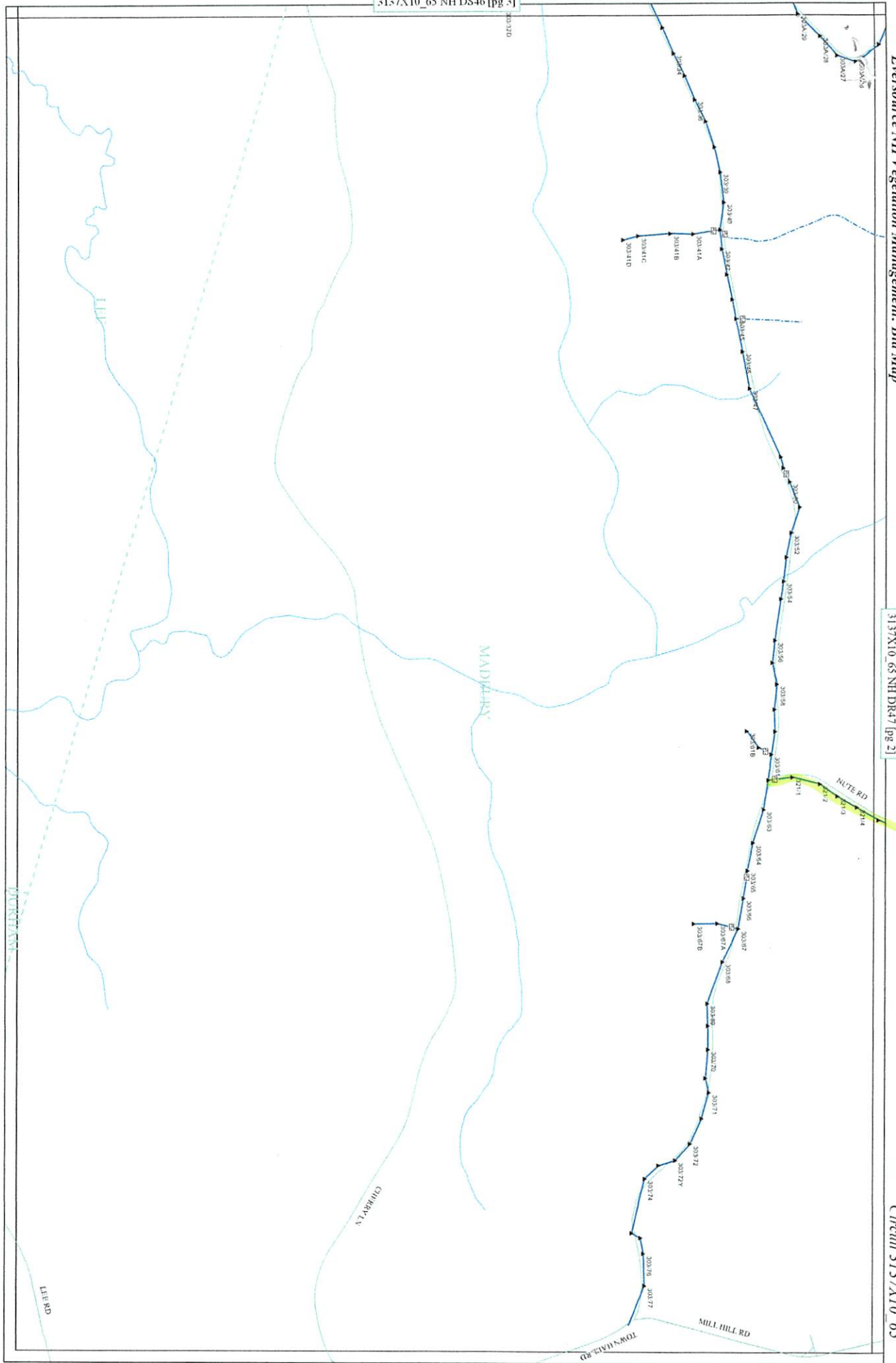

3137X10\_65 NH DS46 [pg 3]

**EVERSOURCE ENERGY GIS**



**Circuit Mileage**



PROPERTY AND INFORMATION: The material contained on this Overhead Distribution Circuit Bid Map is the property of Eversource Energy. It is provided for informational purposes only and is not to be used for any other purpose. Eversource Energy shall not be held liable for any errors or omissions. All rights reserved. Eversource Energy shall not be held liable for any errors or omissions. All rights reserved. Eversource Energy shall not be held liable for any errors or omissions. All rights reserved.

- Cutout
- ▲ Pole
- ▣ Rectifier
- Switch Bank
- || Open Point
- ▲ Stepdown Bank
- ▲ Tiepoint
- OH Primary
- OH Backbone
- OH Lateral
- UG Primary
- UG Backbone
- UG Lateral
- Hydrology
- Streets
- Substation
- Town Boundaries

Backbone	2.30
Lateral	12.32
Total	14.63

Page: 4 of 5

**3137X10\_65 NH DS47**  
 Circuit: 3137X10\_65  
 District: Eastern  
 AWC: Epping  
**EVERSOURCE ENERGY**

